

INSTALLATION INSTRUCTION
ISTRUZIONI DI MONTAGGIO
INSTALLATIONSANLEITUNG
INSTRUCTIONS D'INSTALLATION
INSTRUCCIONES DE MONTAJE

ZERO COMPASSO
WALLWASHER 42 / 66 / 100
EVO 48V TRACK

48V Low Voltage Track Lighting

Lampada per binari a basso voltaggio 48V

48V Low-Voltage-Schienensysteme Leuchten

Éclairage de voie basse tension 48V

Luminarias de pista de bajo voltage 48V

Art.

9673

96E5

9671

96E6

9672

96E7

For Art. 9673, 9671, 9672.

For Art. 96E5, 96E6, 96E7

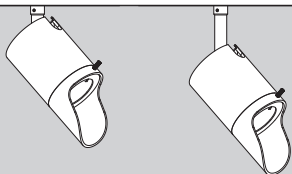

CAUTIONS

AVVERTENZE, WARNUNG
PRECAUTIONS, PRECAUCIONES

1. Switch-off the power supply before any installation and maintenance operations.
Use only a two-pole switch

Staccare la linea elettrica prima dell'installazione e di ogni intervento di manutenzione.
Utilizzare un interruttore bipolare

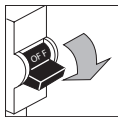

Die Stromzufuhr muss vor der Installation /
Wartung ausgechaltet werden.
Nur mit einen zweipoligen Stecker zu verwenden

Couper la source d'alimentation avant toute
installation et opération d'entretien.
Seulement utiliser avec un connecteur bipolaires

No efectuar la conexión de la lámpara con la
tensión general activada.
Usar un interruptor bipolar

2. Installation must be carried out only by qualified personnel according to safety norms and local regulations.

L'installazione deve essere effettuata da
personale qualificato secondo la normativa
elettrica vigente.

Die Installation muss nach den gültigen
Sicherheitsvorschriften durch einen
konzessionierten Elektroinstallateur erfolgen.

L'installation doit être réalisée par un électricien
qualifié en respectant les prescriptions en
vigueur.

La instalación debe ser realizada por una
persona cualificada y de acuerdo a la normativa
vigente.

3. Use this light fixture at the rated voltage and frequency as indicated on the specification table.

Utilizzare questo apparecchio a tensione e
frequenza indicate nella tabella.

Die Leuchte darf nur mit der angegebenen
Spannung und Frequenz betrieben werden.

Respecter les prescriptions de tension et de
fréquence indiquées dans le tableau final.

Utilice esta lámpara a la tensión y frecuencia
indicadas en las instrucciones.

4. This installation manual must be retained by the person responsible for the installation and maintenance of the product.

Queste istruzioni di montaggio devono essere
conservate dal responsabile dell' installazione e
manutenzione dell' apparecchio.

Bewahren Sie diese Gebrauchsanweisung für den
verantwortlichen Benutzer / Wartungstechniker
auf.

Gardez cette instruction pour l'utilisateur /
technicien de maintenance.

Estas instrucciones deben ser conservadas
por el responsable de mantenimiento de la
instalación.

INSTALLATION

INSTALLAZIONE, MONTAGE, INSTALLATION, INSTALACIÓN

1

Track Type Compatibility

Tipi di binari compatibili, Stromschienen Type-Kompatibilität
Compatibilitat des types de pistes, Compatibilitat con el tipo de pista

For Art. 9673, 9671, 9672
Zero Compasso Wallwasher
EVO 48V

Surface Track
2ST1



Surface Track
Pendant Track
2ST6



Deep Pendant Track
For Up Side
2ST9

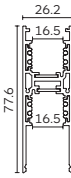

Pendant Track
For Up & Down
2ST7

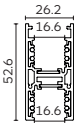

Recessed Track
Trim
2ST8



Recessed Track Trimless
2ST3

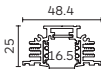

For Art. 96E5, 96E6, 96E7
Zero Compasso Wallwasher
Long Arm EVO 48V

Deep Surface Track
Deep Pendant Track
2ST2

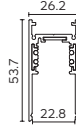

Deep Pendant Track
For Up & Down
2ST9

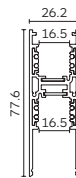

Deep Recessed Track
Trimless
2ST5

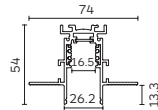

Deep Recessed Track
Trimless
2ST4

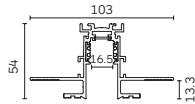

2

For Art. 9673, 9671, 9672.

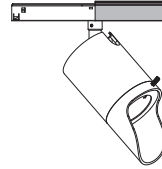

For Art. 96E5, 96E6, 96E7.

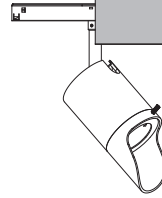

3

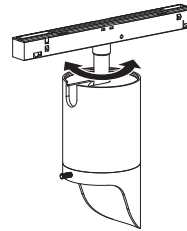

4

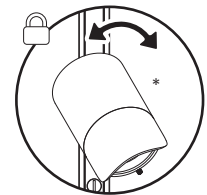
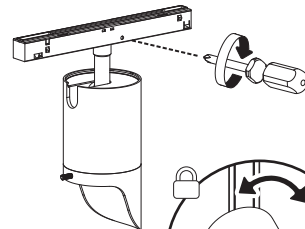

* For Zero Compasso Wallwasher 42 / 66 / 100 EVO 48V

5

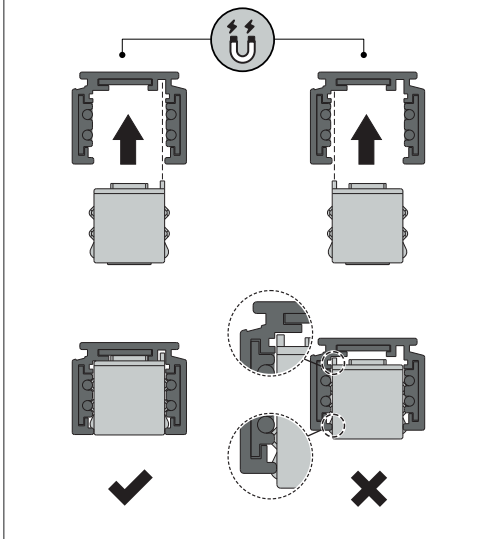
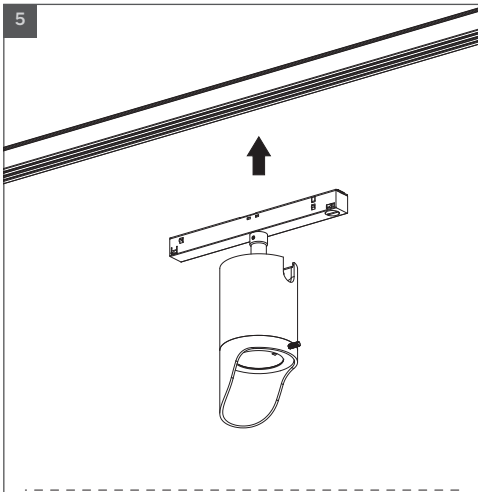

6

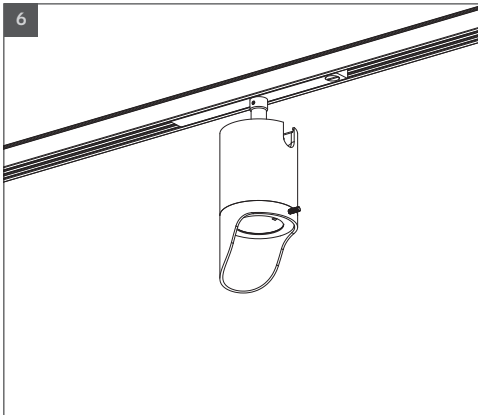

7

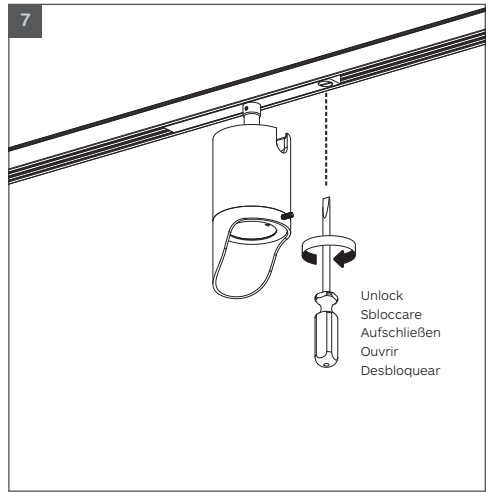

ANGLE ADJUSTMENT

ORIENTAMENTO DEL VANO OTTICO,
ORIENTUNG DER OPTISCHEN,
ORIENTATION DU GROUPE OPTIQUE,
ORIENTABILIDAD DE LA OPTICA

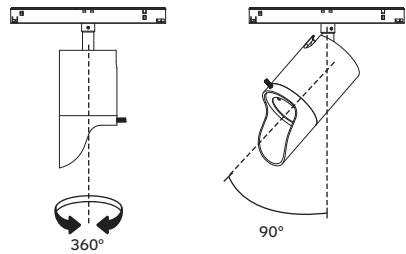

MEASUREMENTS

DIMENSIONI, ABMESSUNGEN,
DIMENSIONS, MEDIDAS

in mm

Zero Compasso
Wallwasher 42
Art.: 9673

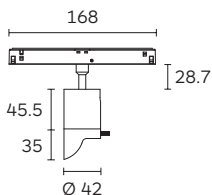

Zero Compasso
Wallwasher 42
Long Arm
Art.: 96E5

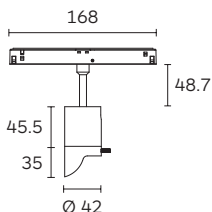

Zero Compasso
Wallwasher 66
Art.: 9671

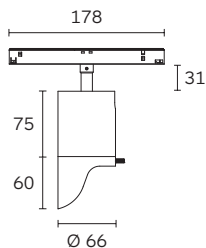

Zero Compasso
Wallwasher 66
Long Arm
Art.: 96E6

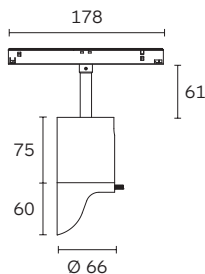

Zero Compasso
Wallwasher 100
Art.: 9672

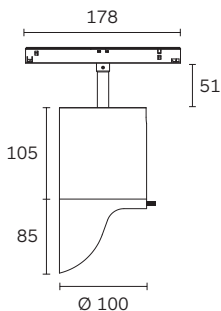

Zero Compasso
Wallwasher 100
Long Arm
Art.: 96E7

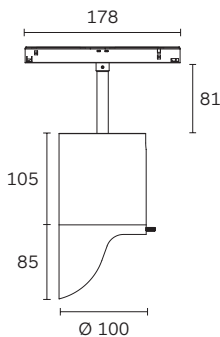

SPECIFICATION

CARATTERISTICHE, BESCHREIBUNG,
CARACTERISTIQUES, ESPECIFICACIONES

Art.	Max Wattage (W)	Voltage (V)	Lamp	Remarks	Class
9673 96E5	4	48	LED	*	
9671 96E6	12	48	LED	*	
9672 96E7	14	48	LED	*	

* LED and LED driver included.
LED e alimentatore compresi.
Inklusive LED und LED Driver.
LED et driver LED inclus.
LED y alimentador incluidos.

For LED replacement, please contact us.

Per rimpiazzare il LED, la preghiamo di contattarci.

Pour le remplacement de LED, s'il vous plait contactez-nous.

Zum Austausch des LEDs, bitte setzen Sie in Verbindung mit uns.

Para reemplazar el LED, por favor contacte con nosotros.



formalighting

Forma Lighting (Italia) S.r.l.

T: (+39) 02 9354 0300

F: (+39) 02 9343 5117

E: formaitalia@formalighting.it

Address: Via Europa, 35/A
20005 Pogliano Mil.se MI

Forma Lighting (HK) Ltd.

T: (+852) 2516 6500

F: (+852) 2516 6525

E: forma@forma.com.hk

Address: Room 4, 5/F.,
Eastern Harbour Centre
28 Hoi Chak Street
Quarry Bay, Hong Kong